

NOTES:

1. FOR MORE SPECIFIC TEST HOLE DATA SEE THE SOILS AND GEOLOGICAL SECTION OF THE LYONS COMPREHENSIVE PLAN.

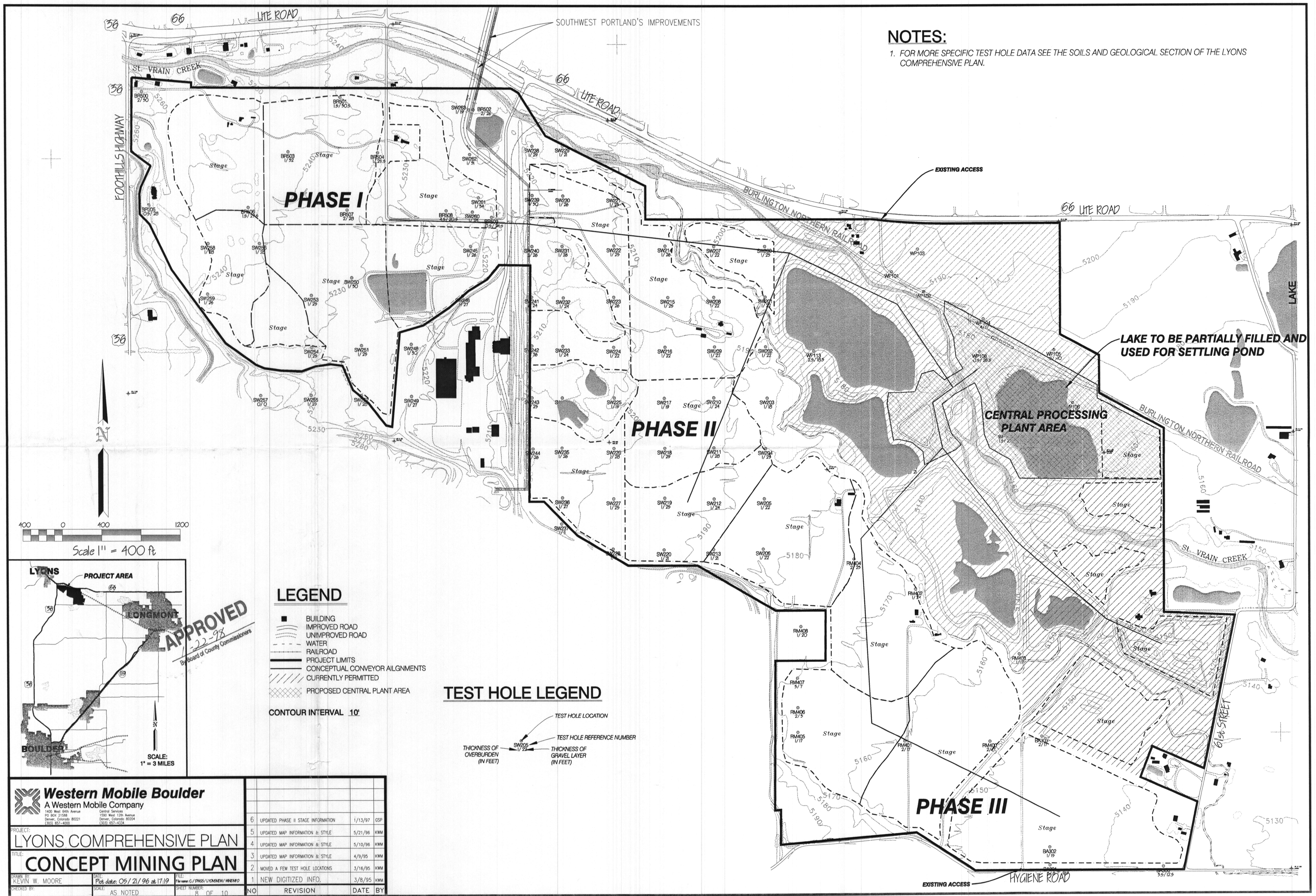

LAKE TO BE PARTIALLY FILLED AND USED FOR SETTLING POND

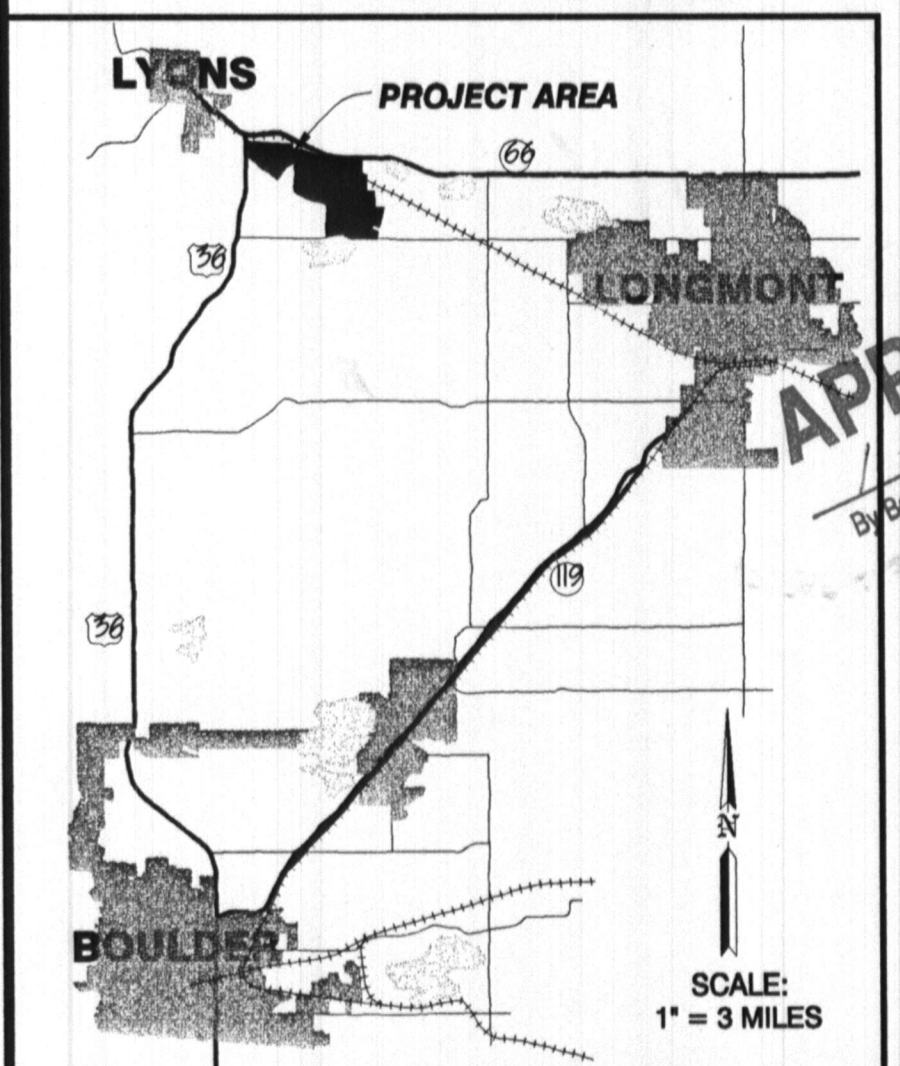
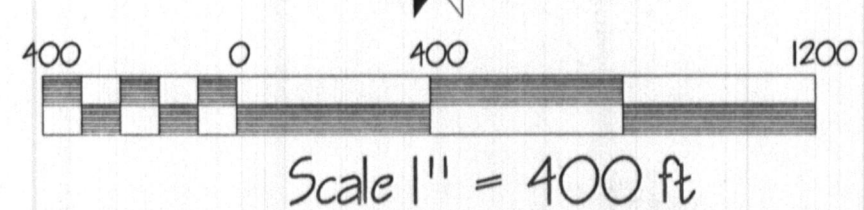

APPROVED
2-22-98
By Board of County Commissioners

LEGEND

- BUILDING
- IMPROVED ROAD
- UNIMPROVED ROAD
- WATER
- RAILROAD
- PROJECT LIMITS
- CONCEPTUAL CONVEYOR ALIGNMENTS
- CURRENTLY PERMITTED
- PROPOSED CENTRAL PLANT AREA

CONTOUR INTERVAL 10'

TEST HOLE LEGEND

- TEST HOLE LOCATION
- TEST HOLE REFERENCE NUMBER
- THICKNESS OF OVERBURDEN (IN FEET)
- THICKNESS OF GRAVEL LAYER (IN FEET)

Western Mobile Boulder
A Western Mobile Company
1100 West 14th Avenue
PO BOX 21588
Denver, Colorado 80221
303.757.4000

PROJECT: **LYONS COMPREHENSIVE PLAN**
TITLE: **CONCEPT MINING PLAN**

DESIGNED BY: KEVIN W. MOORE
DATE: 05/21/96 at 17:19
SCALE: AS NOTED

NO	REVISION	DATE	BY
6	UPDATED PHASE II STAGE INFORMATION	1/13/97	GSP
5	UPDATED MAP INFORMATION & STYLE	5/21/96	KWM
4	UPDATED MAP INFORMATION & STYLE	5/10/96	KWM
3	UPDATED MAP INFORMATION & STYLE	4/9/95	KWM
2	MOVED A FEW TEST HOLE LOCATIONS	3/16/95	KWM
1	NEW DIGITIZED INFO.	3/8/95	KWM