

WILLOUGHBY CORNER PLANNED UNIT DEVELOPMENT

LOCATED IN THE SE 1 / 4 OF SECTION 2, T1S, R69W OF THE 6TH P.M.,
CITY OF LAFAYETTE, COUNTY OF BOULDER, STATE OF COLORADO

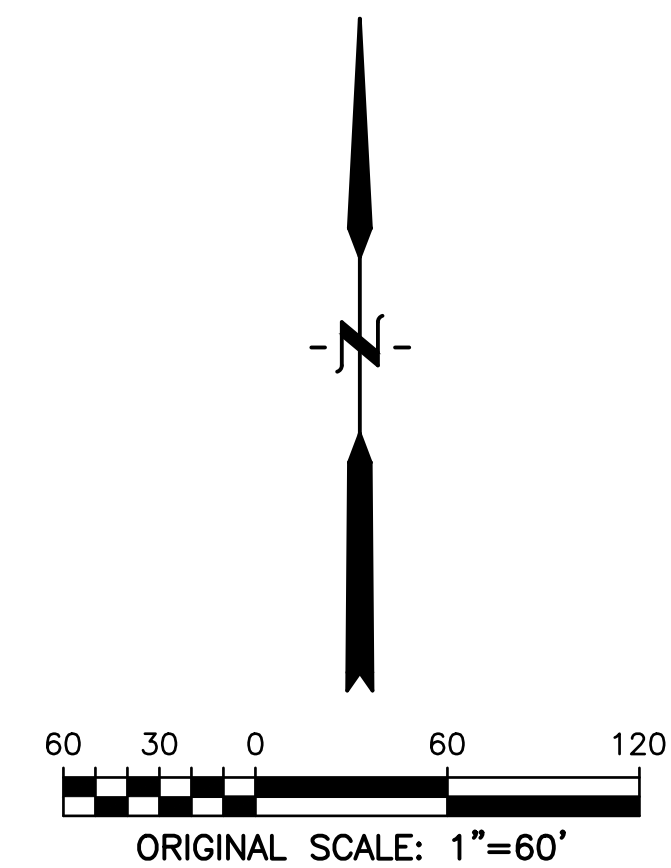

LEGEND

- AASHTO SIGHT DISTANCE TRIANGLE
- ALLEY 15' NO OBSTRUCTION ZONE
- STOP STOP SIGN

NOTE:
ABOVE LEGEND DEPICTS ALL SIGHT TRIANGLES SHOWN
HEREON. ALL SIGHT TRIANGLES WILL FOLLOW AASHTO
STANDARDS. ALL SIGHT VISION CLEARANCE CITY STANDARDS,
AS DESCRIBED IN CODE SECTION 26-14-16 WILL BE FOLLOWED
FOR AASHTO LOCATIONS. ALL OF SIGHT TRIANGLE SHOWN
ARE NOT CITY STANDARD ARE MODIFICATIONS BY THIS PUD.

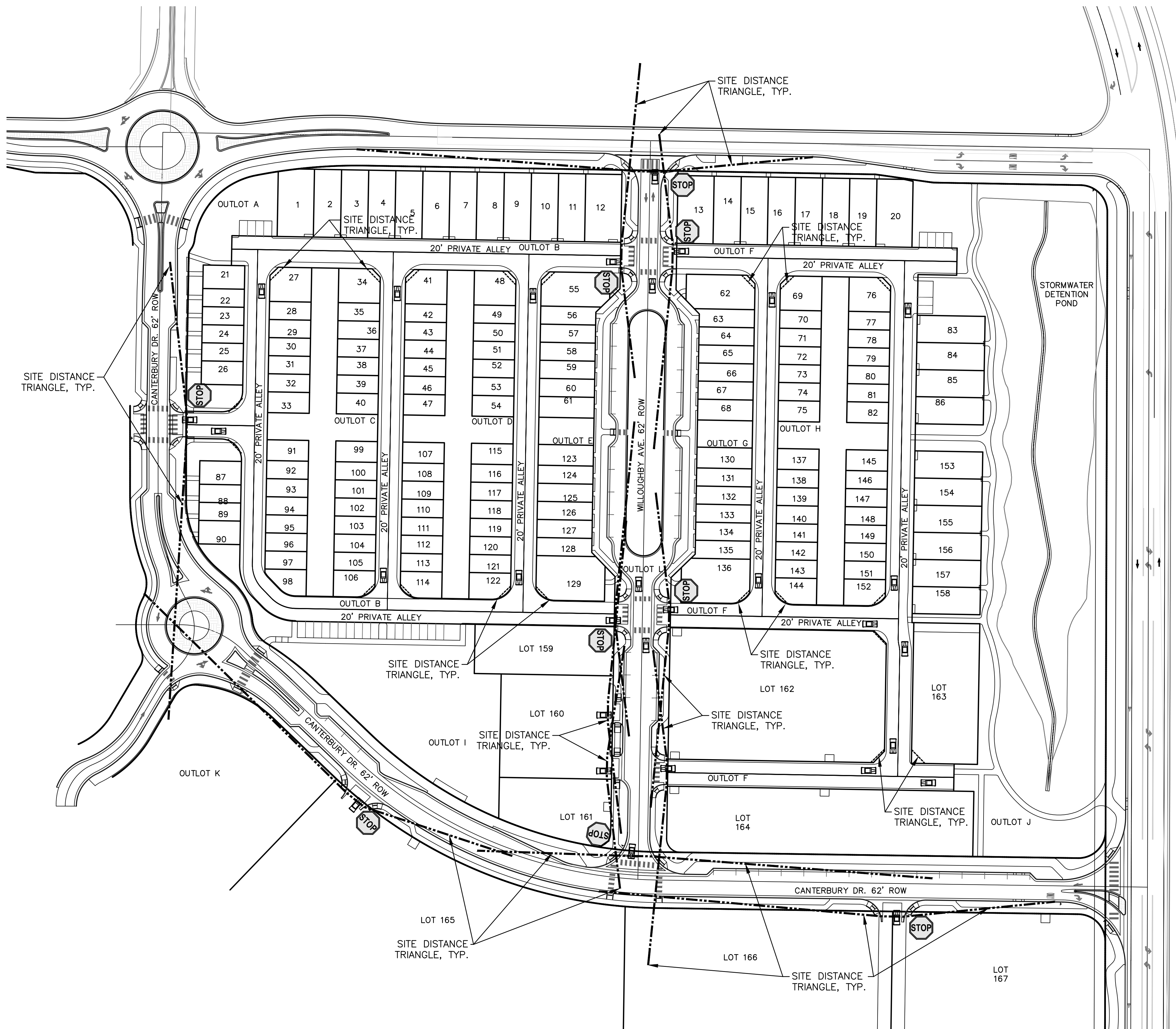

WILLOUGHBY CORNER
PLANNED UNIT DEVELOPMENT
LAFAYETTE, COLORADO

OWNER:
BOULDER COUNTY HOUSING
AUTHORITY
3400 BROADWAY
BOULDER, CO - 80304
303.441.3861
CONTACT: MOLLY CHIANG

DATE:
1ST SUBMITTAL: 12.14.21
2ND SUBMITTAL: 03.07.22

DRAFT

SHEET TITLE:
SITE DISTANCE
EXHIBIT

