



**ADDENDUM #1
Public Works
Hygiene Road at Foothills Reservoir Inlet
BID # 7469-23**

May 30, 2023

The attached addendum supersedes the original Information and Specifications regarding BID # 7469-23 where it adds to, deletes from, clarifies or otherwise modifies. All other conditions and any previous addendums shall remain unchanged.

Please note: BIDS will only be accepted electronically by emailing purchasing@bouldercounty.org.

QUESTIONS AND ANSWERS

1. Question: Are we to add the \$75,000 to the bid schedule for the Force Account Item? It is listed on page 103 of the specs but that dollar amount is not on the bid schedule we are turning in with our bid.

ANSWER: The bid schedule has been revised to show \$75,000 for the Force Account Work.

2. Question: Is there a place on site to stockpile topsoil?

ANSWER: There will be limited space in the staging area that is shown on sheet #47 of the plans.

3. Question: Is there a specific value we should insert in the bid form for the Force account, Minor Contract Revisions item?

ANSWER: The bid schedule has been revised to show \$75,000 for the Force Account Work.

4. Question: Will the pre-bid meeting be rescheduled, and will this project still bid 06/06/23?

ANSWER: The pre-bid meeting will not be rescheduled and the project will still bid 06/06/23.

ADDENDUM #1

1. A revised BID Tab is attached to Addendum #1 that:
 - a. Revises the total units for Item #603-71606 – 16X6 FOOT CONCRETE BOX CULVERT (PRECAST)(INSTALLATION) to reflect what will be manufactured by SEMA Precast.
 - b. Revises the total units for Item #601-03030 – CONCRETE CLASS D (REBAR INCLUDED) to reflect the additional concrete to construct the skewed end sections at each end of the concrete box culvert.
 - c. Shows \$75,000 total cost for Item #700-70010 – MINOR CONTRACT REVISIONS.
2. Exhibit A is attached to Addendum #1 which shows the length of the 16X6 foot precast concrete box culvert that will be manufactured by SEMA Precast. Exhibit A also shows the skewed end sections of the concrete box culvert that will be constructed with the project.

Submittal Instructions:

Submittals are due at the email box only, listed below, for time and date recording on or before **2:00 p.m. Mountain Time on June 6, 2023.**

Please note that email responses to this solicitation are limited to a maximum of 50MB capacity.

NO ZIP FILES OR LINKS TO EXTERNAL SITES WILL BE ACCEPTED. THIS INCLUDES GOOGLE DOCS AND SIMILAR SITES. ALL SUBMITTALS MUST BE RECEIVED AS AN ATTACHMENT (E.G. PDF, WORD, EXCEL).

Electronic submittals must be received in the email box listed below. Submittals sent to any other box will NOT be forwarded or accepted. This email box is only accessed on the due date of your questions or proposals. Please use the Delivery Receipt option to verify receipt of your email. It is the sole responsibility of the proposer to ensure their documents are received before the deadline specified

above. Boulder County does not accept responsibility under any circumstance for delayed or failed email or mailed submittals.

Email purchasing@bouldercounty.org; identified as **BID # 7469-23** in the subject line.

All proposals must be received and time and date recorded at the purchasing email by the above due date and time. Sole responsibility rests with the Offeror to see that their bid is received on time at the stated location(s). Any bid received after due date and time will be returned to the bidder. No exceptions will be made.

The Board of County Commissioners reserve the right to reject any and all bids, to waive any informalities or irregularities therein, and to accept the bid that, in the opinion of the Board, is in the best interest of the Board and of the County of Boulder, State of Colorado.



**RECEIPT OF LETTER
ACKNOWLEDGMENT**

May 30, 2023

Dear Vendor:

This is an acknowledgment of receipt of Addendum #1 for BID #7469-23, Hygiene Road at Foothills Reservoir Inlet.

In an effort to keep you informed, we would appreciate your acknowledgment of receipt of the preceding addendum. Please sign this acknowledgment and email it back to purchasing@bouldercounty.org as soon as possible. If you have any questions, or problems with transmittal, please call us at 303-441-3525. This is also an acknowledgement that the vendor understands that **BIDS will only be accepted electronically by emailing purchasing@bouldercounty.org.**

Thank you for your cooperation in this matter. This information is time and date sensitive; an immediate response is requested.

Sincerely,

Boulder County Purchasing

Signed by: _____ **Date:** _____

Name of Company _____

End of Document



Boulder County Purchasing
1325 Pearl Street
Boulder, CO 80302
purchasing@bouldercounty.org

BID TAB (REVISED 5/30/2023)

ITEM NO.	ITEM DESCRIPTION	UNIT	TOTAL UNITS	UNIT COST	TOTAL COST
201-00000	CLEARING AND GRUBBING	LS	1	_____	_____
202-00010	REMOVAL OF TREE	EA	10	_____	_____
202-00020	REMOVAL OF BOX CULVERT	EA	1	_____	_____
202-00035	REMOVAL OF PIPE	LF	42	_____	_____
202-00220	REMOVAL OF ASPHALT MAT	SY	3,575	_____	_____
202-00810	REMOVAL OF GROUND SIGN	EA	9	_____	_____
202-01130	REMOVAL OF GUARDRAIL	LF	135	_____	_____
202-01000	REMOVAL OF FENCE	LF	90	_____	_____
202-01400	REMOVAL OF CATTLE GUARD	EA	1	_____	_____
203-01598	POTHOLING (SPECIAL)	EA	4	_____	_____
203-00060	EMBANKMENT (COMPLETE IN PLACE)	CY	855	_____	_____
206-00000	STRUCTURE EXCAVATION	CY	540	_____	_____
206-00100	STRUCTURE BACKFILL (CLASS 1)	CY	131	_____	_____
206-01750	SHORING (TEMPORARY)	LS	1	_____	_____
207-00210	STOCKPILE TOPSOIL	CY	369	_____	_____
207-00700	TOPSOIL (ONSITE)	CY	269	_____	_____

207-00702	TOPSOIL (OFFSITE)	CY	100	_____	_____
207-00706	SEEDING MEDIA	CY	150	_____	_____
208-00002	EROSION LOG TYPE 1 (12 INCH)	LF	500	_____	_____
208-00020	SILT FENCE	LF	635	_____	_____
208-00045	CONCRETE WASHOUT STRUCTURE	EA	1	_____	_____
208-00075	PRE-FABRICATED (VEHICLE TRACKING PAD)	EA	2	_____	_____
208-00301	TEMPORARY DIVERSION	LS	1	_____	_____
210-00810	RESET GROUND SIGN	EA	8	_____	_____
210-00815	RESET SIGN PANEL	EA	8	_____	_____
210-01000	RESET FENCE	LF	388	_____	_____
210-01011	RESET GATE	EA	1	_____	_____
211-03005	DEWATERING	LS	1	_____	_____
212-00700	ORGANIC FERTILIZER	LB	35	_____	_____
216-00201	SOIL RETENTION BLANKET (STRAW-COCONUT) (BIODEGRADABLE CLASS 1)	SY	500	_____	_____
218-00000	NOXIOUS WEED MANAGEMENT	HR	30	_____	_____
240-00000	WILDLIFE BIOLOGIST	HR	8	_____	_____
240-00010	REMOVAL OF NESTS	HR	8	_____	_____
240-00020	NETTING	SY	50	_____	_____
240-00100	PRAIRIE DOG MANAGEMENT	LS	1	_____	_____
304-06000	AGGREGATE BASE COURSE (CLASS 6)	TON	1727	_____	_____
403-33741	HOT MIX ASPHALT (GRADING S) (75) (PG 64-22)	TON	1231	_____	_____
403-34742	HOT MIX ASPHALT (GRADING SX) (75) (PG 64-22)	TON	615	_____	_____
506-00212	RIPRAP (12 INCH)	CY	75	_____	_____
515-00120	WATERPROOFING (MEMBRANE)	SY	156	_____	_____
601-03030	CONCRETE CLASS D (REBAR INCLUDED)	CY	52	_____	_____
603-01155	15" RCP	LF	51	_____	_____
603-71606	16X6 FOOT CONCRETE BOX CULVERT (PRECAST)(INSTALLATION)	LF	59	_____	_____

606-02003	END ANCHORAGE (NONFLARED)	EA	1		
606-01340	END ANCHORAGE TYPE 3D	EA	1		
606-00302	GUARDRAIL TYPE 3 W-BEAM (7' POSTS)	LF	105		
607-11530	FENCE	LF	101		
611-00016	16 FOOT CATTLE GUARD	EA	1		
614-00011	SIGN PANEL (CLASS 1)	SF	155		
614-00220	STEEL SIGN POST (2.5X2.5X INCH TUBING)	LF	260		
614-01564	STEEL SIGN POST (2.5 INCH SQUARE SOCKET)	EA	26		
619-00005	WATER LINE (EXTENSION)	LS	1		
619-00006	CONNECT TO EXISTING WATER LINE	EA	2		
620-00020	SANITARY FACILITY	EA	1		
625-00000	CONSTRUCTION SURVEYING	LS	1		
626-00000	MOBILIZATION	LS	1		
627-00008	MODIFIED EPOXY PAVEMENT MARKING	GAL	31		
629-01005	SURVEY MONUMENT (TYPE 5)	EA	3		
630-00000	FLAGGING	HR	1440		
630-00007	TRAFFIC CONTROL INSPECTION	DAY	40		
630-00012	TRAFFIC CONTROL MANAGEMENT	DAY	80		
FORCE ACCOUNT					
700-70010	MINOR CONTRACT REVISIONS	F/A	1		\$ 75,000

TOTAL

Enclosed herewith is the required bid bond in the amount of ten percent (10%) (\$_____) which the bidder agrees to be forfeited to and become the property of the County of Boulder as liquidated damage should this proposal be accepted and a Contract be awarded to him and he fails to enter into a Contract in the form prescribed and to furnish the required bonds and insurance within ten days upon his signing the contract and delivering the approved bonds. In submitting the bid it is understood that the right is reserved by the County of Boulder to reject any and all bids.

EXHIBIT A

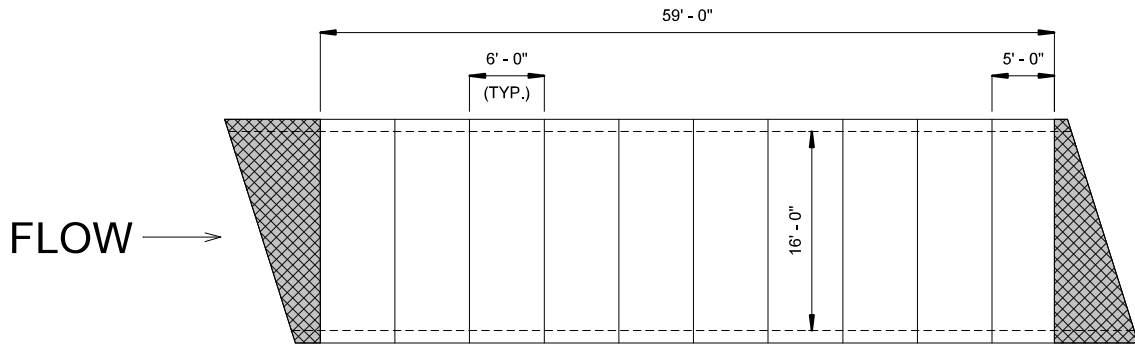

① PLAN VIEW
1" = 10'-0"

= CAST-IN-PLACE AREAS BY OTHERS

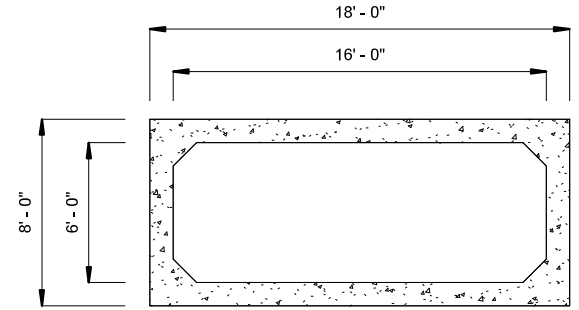

② TYP. SECTION VIEW
3/16" = 1'-0"

NOTES

1. THIS DESIGN SCHEMATIC IS FOR ESTIMATING PURPOSES ONLY AND IS NOT AN ENGINEERED DESIGN
2. CAST-IN-PLACE AREAS ARE TO BE DESIGNED AND CONSTRUCTED BY OTHERS
3. ALL CAST-IN-PLACE DIMENSIONS SHOWN ARE ESTIMATES ONLY AND NOT TO BE CONSIDERED FINAL



SEMA Precast
14585 Brighton Rd
Brighton, CO 80601

Hygiene Road at Foothills
Reservoir

No.	Description	Date

16x6 Box Culvert CIP Locations

Project number	.	A101
Date	04/26/2023	
Designer:	DD	Scale As indicated
Detailer:	DD	